

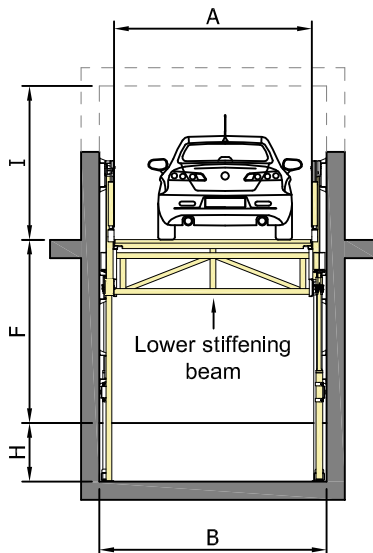

# Technical data

# Mod. IP1-HMT V03

## CAR LIFT

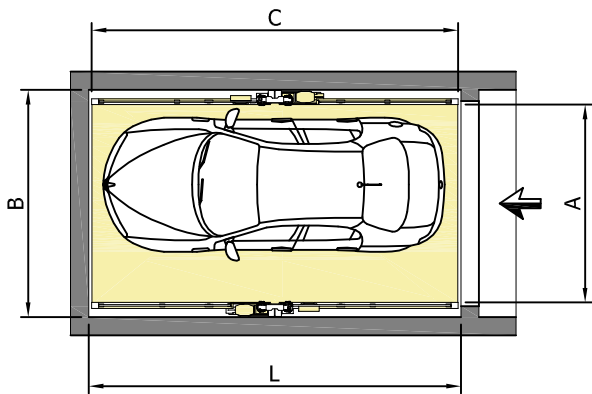
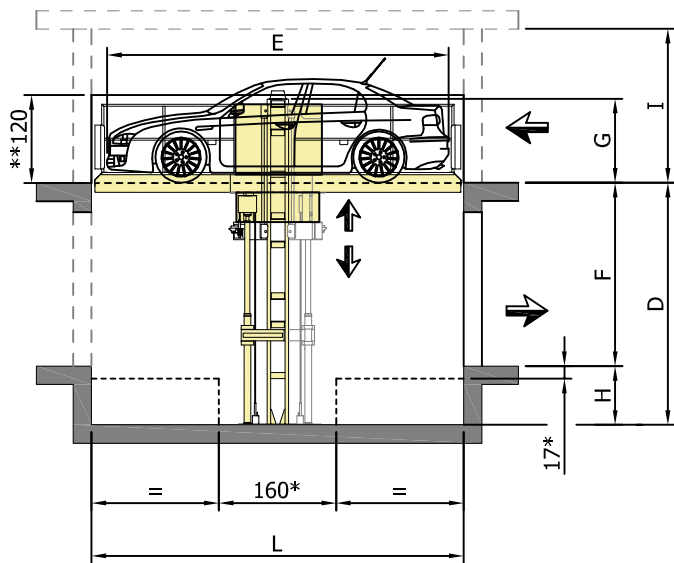

(\*) Minimum size required for shallower pit

(\*\*) Open air installation is possible with side wall H.120 cm

Dimensions are in cm

## TECHNICAL FEATURES

Load (kg)	2700
Motor power (kW)	5,5 (9,5)
Raising speed (m/s)	0,10 (0,15)
Lowering speed (m/s)	0,15

## STANDARD LOADS

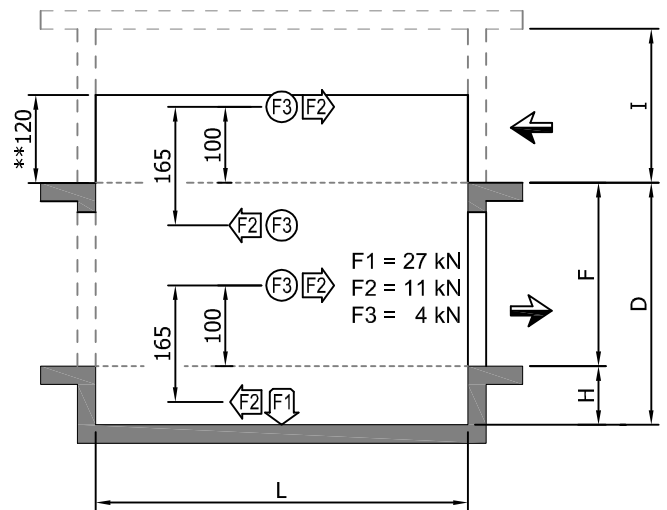

All stress loads include car weight.

Recommended material in the fixing area of the columns: reinforced concrete - R min. = 3,5 kN/cm<sup>2</sup>

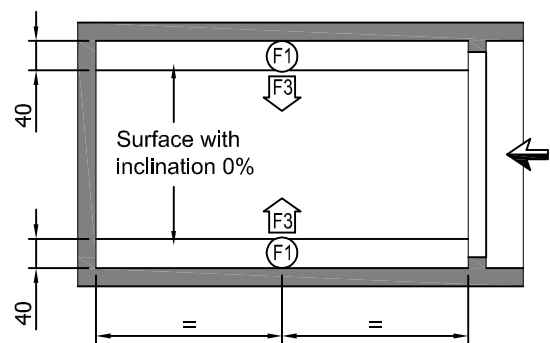

## TECHNICAL DATA

Description	Dimension	Standard	Max
platform width	<b>A</b>	250	270
platform length	<b>C</b>	520	560
car length	<b>E</b>	512	552
pit width	<b>B</b>	290	310
pit length	<b>L</b>	528	568
pit height	<b>H</b> <sup>+4</sup> <sub>0</sub>	80	80
total height	<b>D</b> <sup>±5</sup>	(F + H)	(F + H)
travel	<b>F</b> <sup>±5</sup>	300	1190 (Max)
columns' ledge	<b>G</b>	195 - H	195 - H
headroom	<b>I</b>	205 (Min) **	205 (Min) **

The manufacturer reserves the right to modify or alter above specifications.